

Application:

Change-over valve (quick acting model) according to DIN EN 12514-2 with coupling for the quick isolation or change-over of the fuel supply, for instance for heating oil installations (one pipe system) with 2 tanks.

Models:

Pipe connection

6 x 6 x 6 mm
8 x 8 x 8 mm
10 x 10 x 10 mm
12 x 12 x 12 mm

Item no.:

2102051
2102052
2102053
2102054

Technical data:

Size: Ø 6, 8, 10 and 12 mm

Operating pressure: PN 6

Ambient

temperature: -10 °C up to +60 °C,
0 °C up to +40 °C recommended, see DIN 4755

Body: brass, unplated

Connections: Couplings according to DIN 2353 made of galvanised steel with brass cutting rings

Fluids: Light heating oils on mineral oil basis, e.g. EL type of heating oil according to DIN 51603-1 as well as heating oils with a bio proportion up to 5%

Direction of flow: see arrows on the handle

Installation:

The change-over valve is installed in the pipework (copper pipe according to EN 1057) via the couplings. Suitable reinforcing sleeves are to be used.

The approved rules of technology (e. g. DIN 4755) must be observed.

Operation and maintenance:

The valve is isolated and opened by turning the handle by 90° in any direction. The open position or the direction of flow are displayed by the arrows on the handle.

The valve is maintenance-free.

Accessories:

Brass reinforcing sleeves for copper pipe with a wall thickness of 1 mm

Outer pipe diameter:

6 mm
8 mm
10 mm
12 mm

Item no.:

2083951
2083952
1029651
1029652

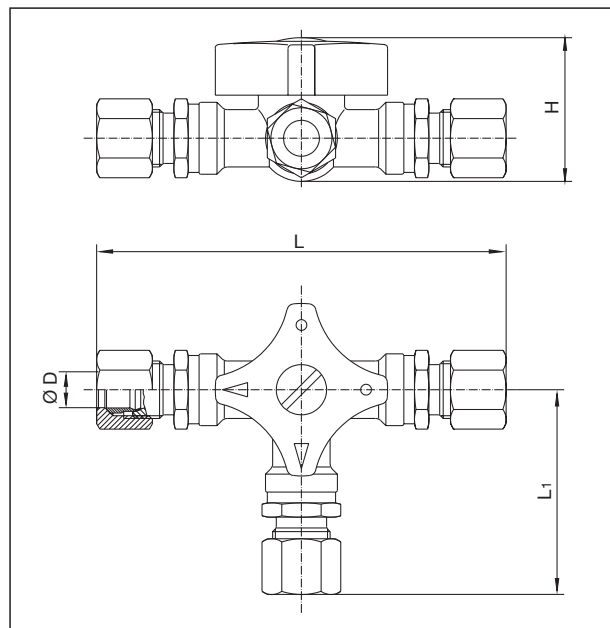

Change-over valve

Item no.:	D x D x D	L ~	L1 ~	H ~
2102051	6 x 6 x 6	110	55	40
2102052	8 x 8 x 8	112	56	40
2102053	10 x 10 x 10	114	57	40
2102054	12 x 12 x 12	116	58	41

Dimensions [mm]

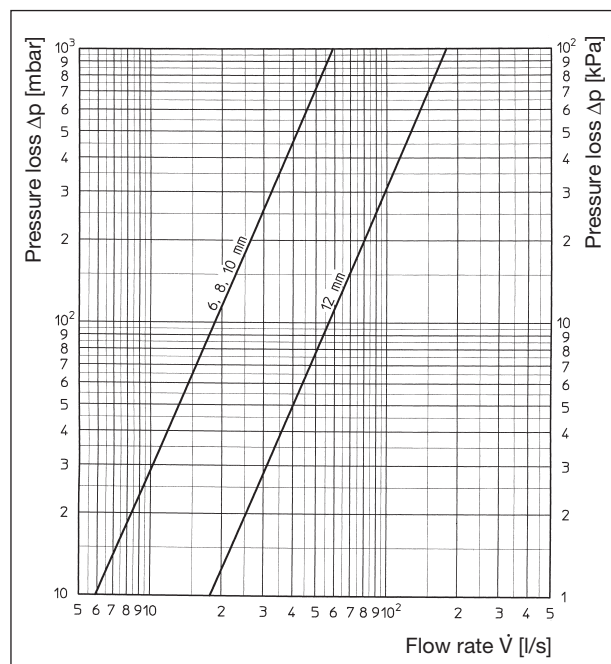

Flow chart

Subject to technical modifications without notice.

Product range 9
ti 221-EN/10/MW
Edition 2016